



## EcoPro / EcoAdd

# The New Pump Generation

- ▲ Variable arrangement of control unit and mounting console
- ▲ Electronically adjustable metering capacity from 1:100
- ▲ Different metering modes adjustable (e.g. for high-viscosity products)
- ▲ USB interface
- ▲ Future-oriented safety and communication tools
- ▲ Multicolor touch display



## Technical data

### Electrical versions:



#### EcoPro

Keys / settings:  
LEDs:  
Inputs:

on/off, test, viscosity high/low, 1:100  
operation, viscosity high/low, alarm  
release



#### EcoAdd

Keys / settings:  
Display:  
Operation mode:  
Inputs:  
Outputs:  
Communication:  
Option:

on/off, 4 viscosity modes, 5 operating modes, 1:100  
touch display  
manual, pulse, current, timer, charge  
release, pulse, current, charge, level, flow, diaphragm break  
stroke signal, alarm  
USB, CAN Bus  
Bluetooth extension module

### General data:

Pump type		5	12	30	54	120
Pump capacity:	l/h	0.05 - 5	0.12 - 11.6	0.3 - 30	0.54 - 54	1.2 - 120
max. metering back pressure	bar	10	10	3	10	3
Connection thread		3/8"	3/8"	5/8"	5/8"	1 1/4"
Reproductivity		+- 3%				
max. suction height	m	2				
max. metering frequency	1/min	155	180	160	160	150
max. viscosity	mPas	600				
max. ambient temperature	°C	5 - 45				
Power supply	V	100 - 240 V +-10% 50/60 Hz				
Safety type		IP 65				

## Variable structure

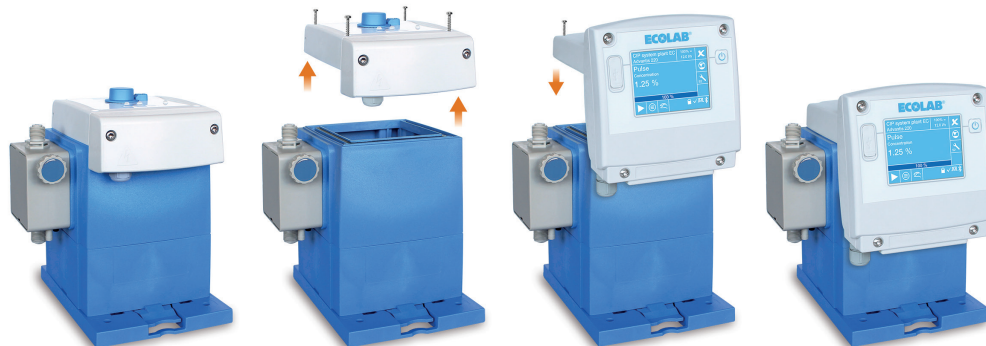

Upgrade from **EcoPro** to **EcoAdd**



Control unit turned by **90°**